

- 凡 例**
- 建 物**
- ⊕ 未とりこわし建物
  - ⊖ 危険建物
  - 借 借用建物
  - ⊖ 一時使用建物
  - ⊖ 屋外教育環境整備事業によるもの
- 建物以外の工作物**
- ⊖ 自転車置場
  - 吹 吹き抜けの渡廊下
  - 開 開放廊下
  - 動 動物小屋

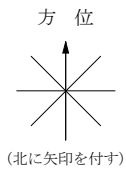

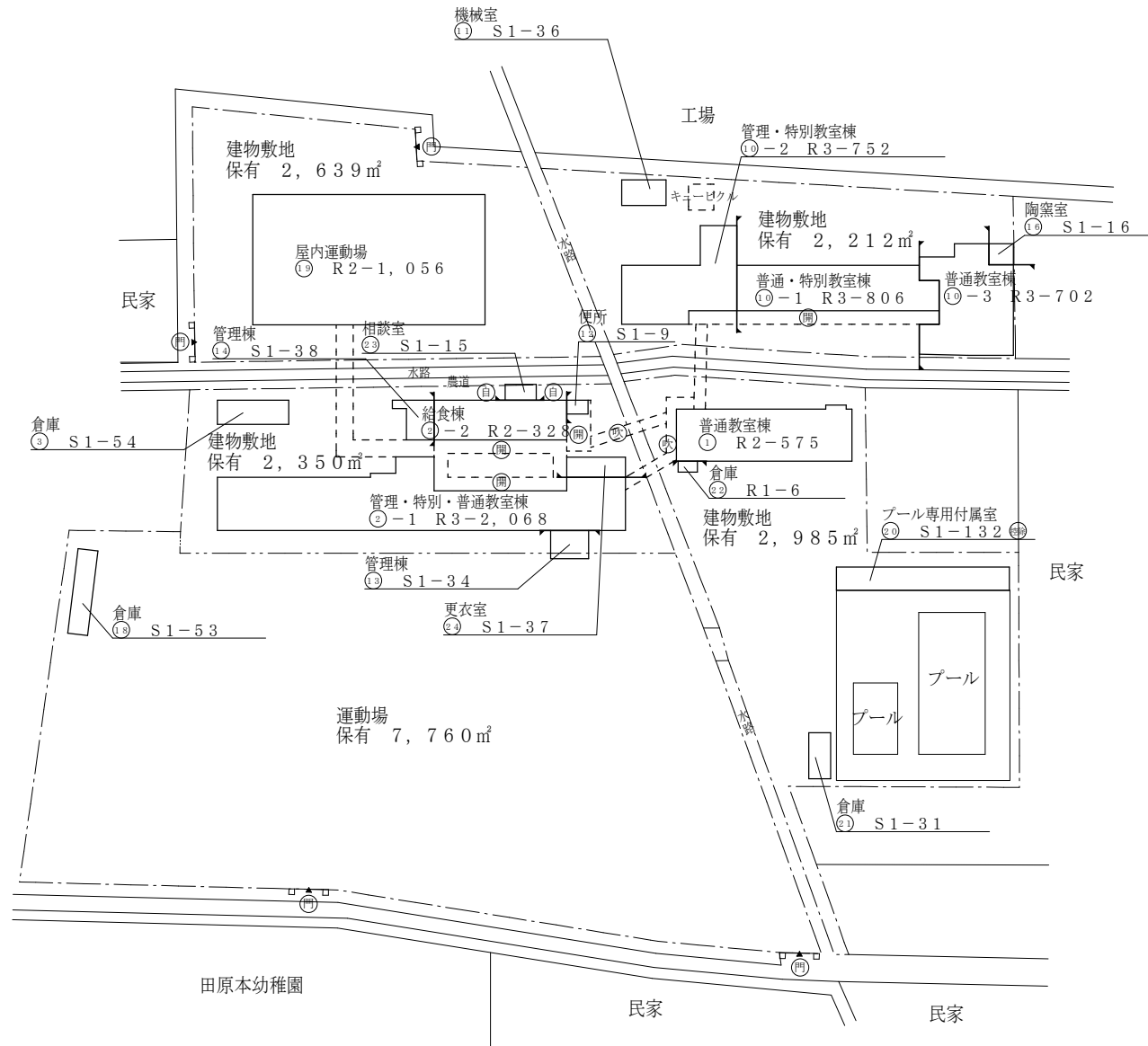

保有控除  
給食室 38.00㎡

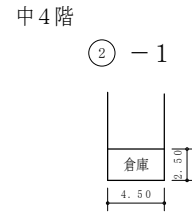
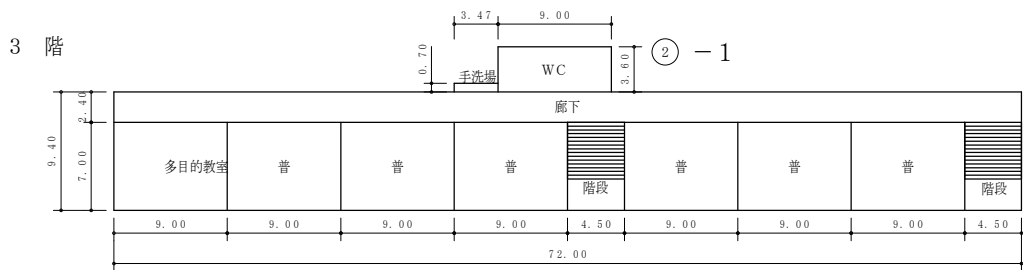
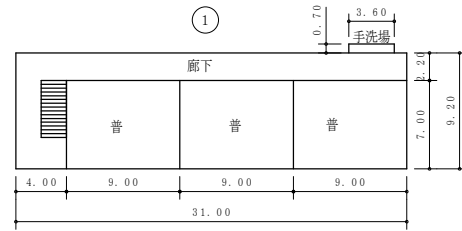
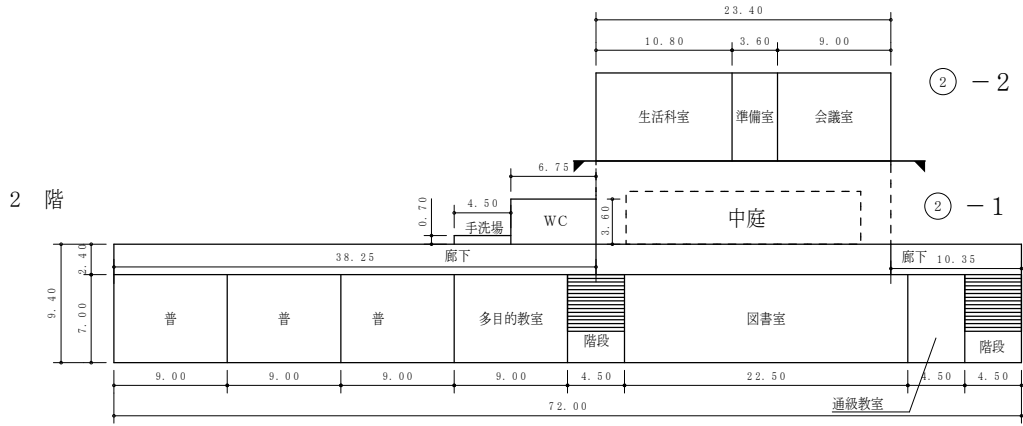
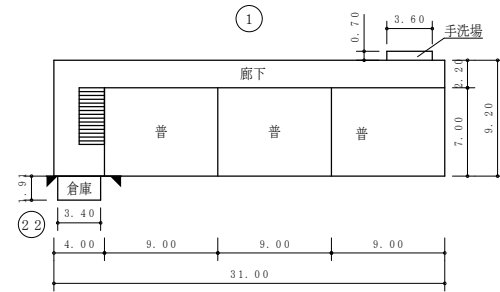
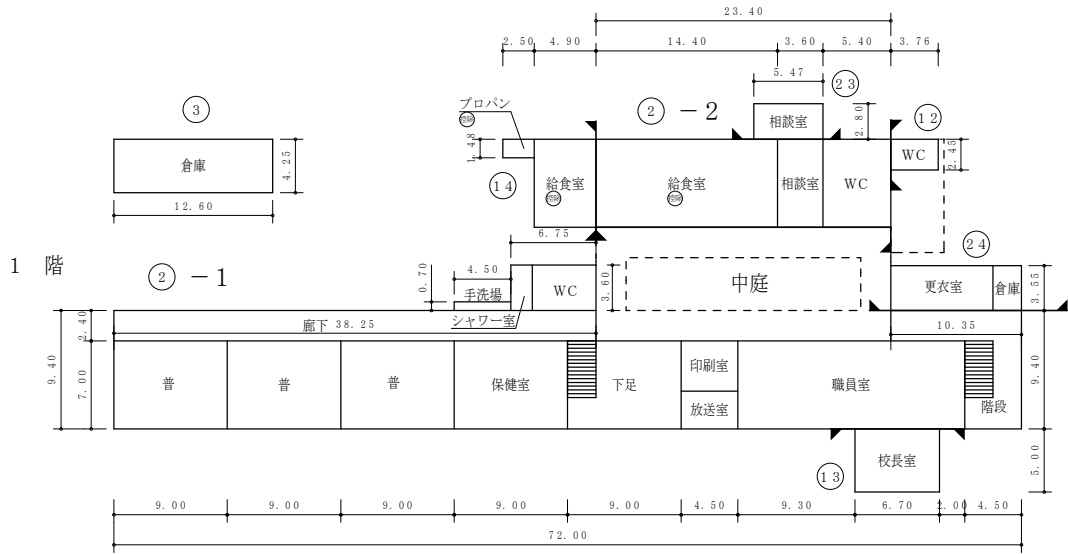
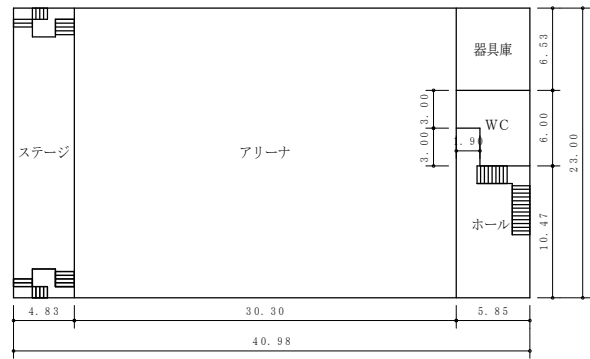

19 1階

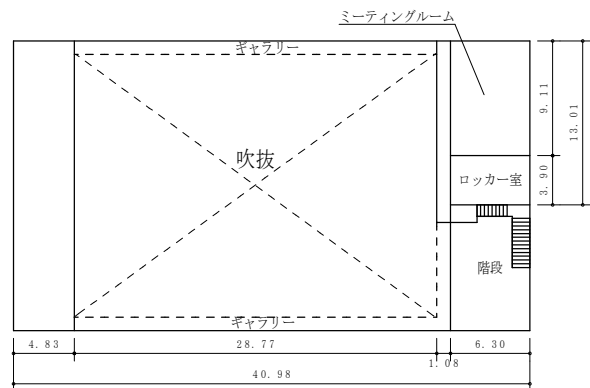

19 2階

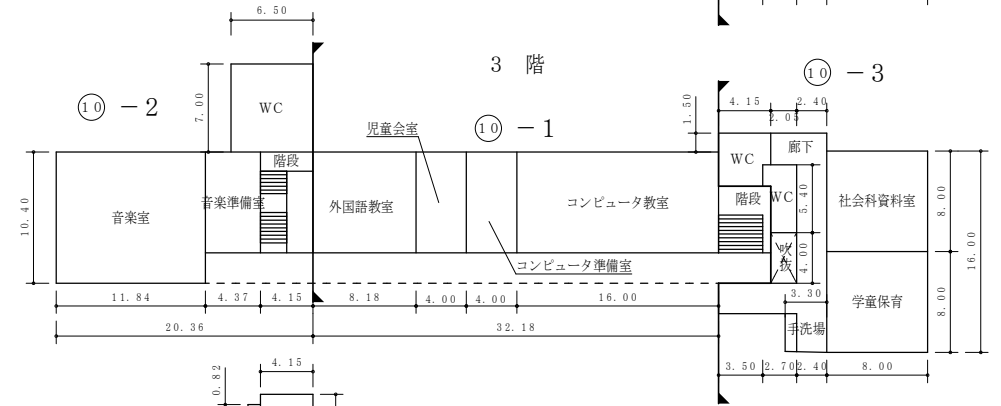
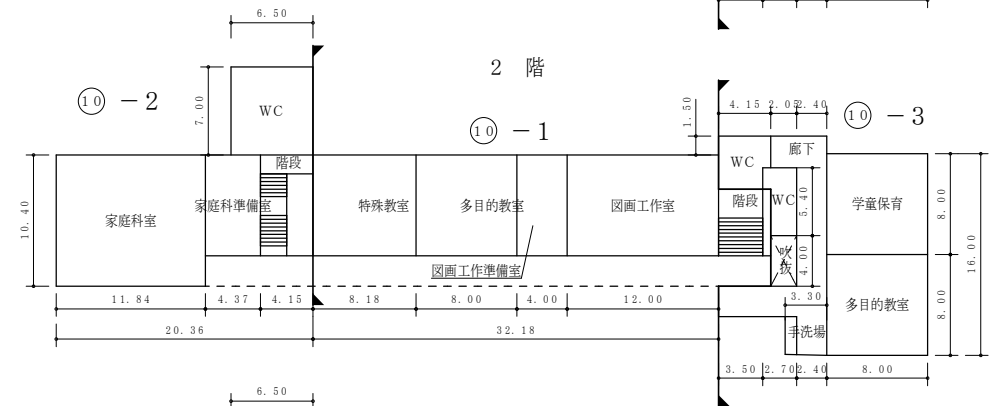
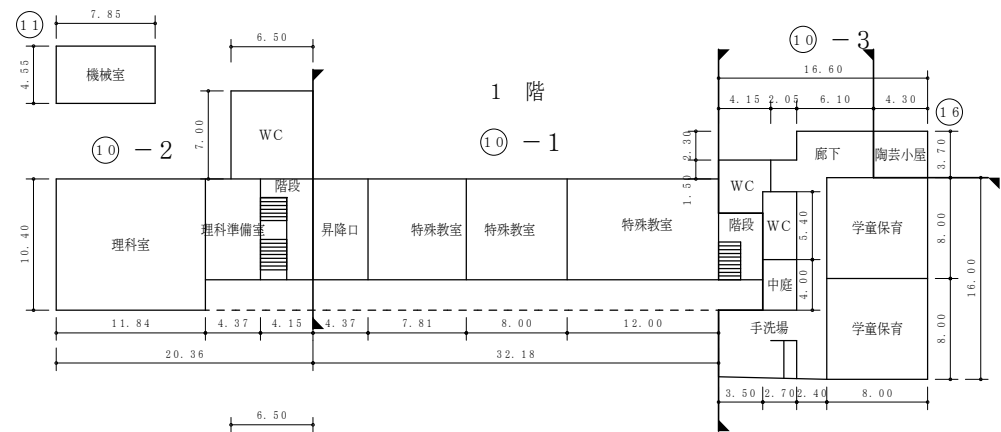
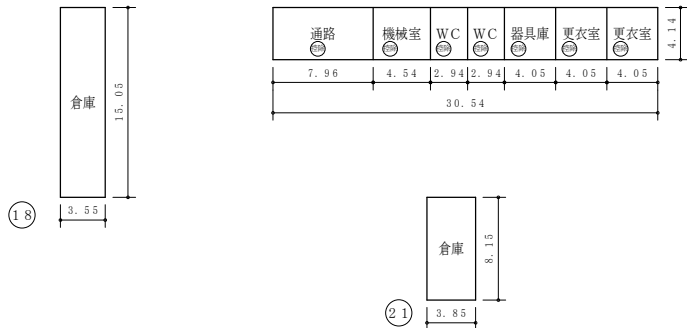

保有控除  
プール専用付属室 131.99㎡